

# Espresso Coffee Machine

Model : i-Creo

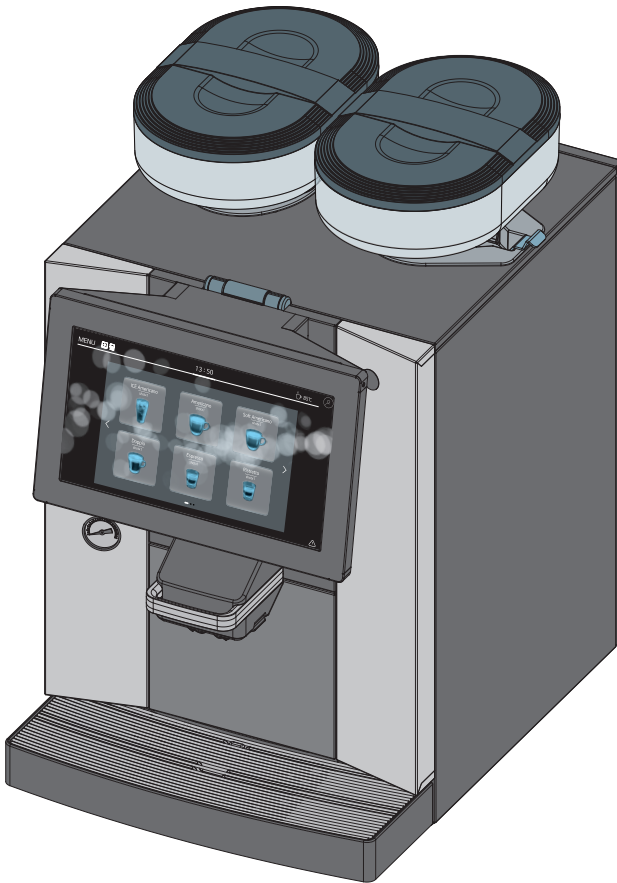

# Table of Contents

1. Table of Contents.....	1
2. Components & Accessories.....	2
3. Safety Precautions .....	3
4. Installation and Operation	
4-1. Installation Conditions.....	5
4-2. Installing/Removing the Bean Canister .....	6
4-3. Filling the Bean Canister .....	6
4-4. Adjusting the Grind Level .....	7
4-5. Adjusting the Coffee Nozzle.....	7
4-6. Lifting the Front Panel.....	8
4-7. Rinsing the Brewer.....	8
4-8. Cleaning the coffee nozzle.....	9
4-9. Emptying the Bean Residue Box .....	9
4-10. Start screen.....	10
4-11. Single Sale .....	11
4-12. Multi-Sale .....	12
5. Administrator Mode	
5-1. Entering Administrator Mode .....	13
5-2. Rinsing Mode.....	13
5-3. Administrator Mode Screen.....	14
5-4. Sales Configuration Settings .....	14
5-5. Sales Management .....	15
5-6. Menu Management .....	16
5-7. System Setting .....	19
5-8. Error Information.....	21
5-9. Load Test .....	21
5-10. Machine Setting .....	23
5-11. Information .....	25
6. Product Specification.....	25

# Components

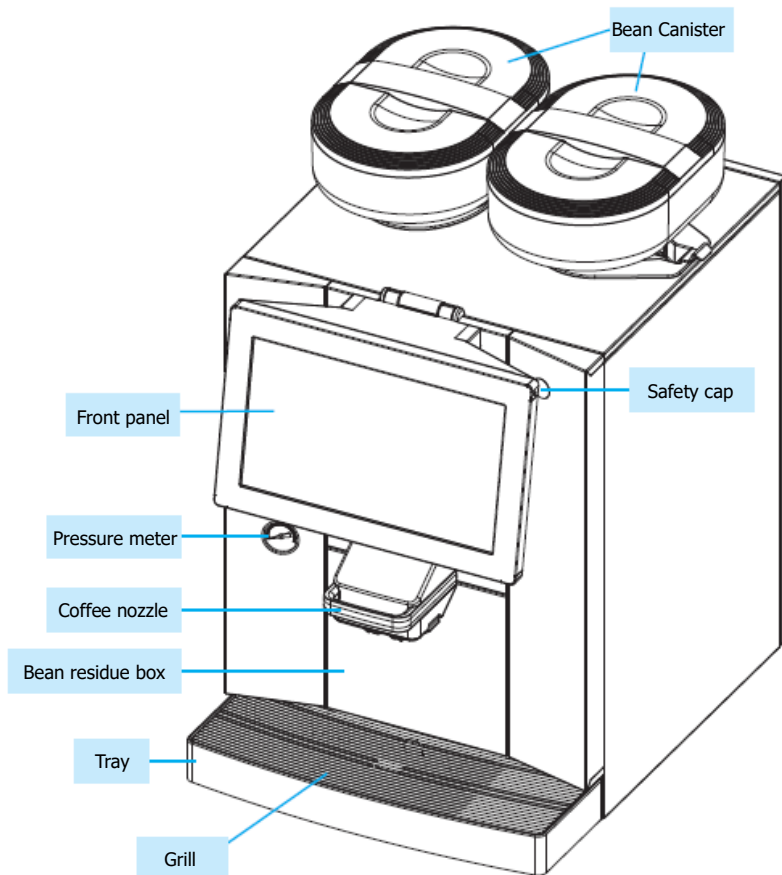

## Accessories



Spare fuse



Manual



Bean Canister  
(2 ea)



Bean Container  
Fixing Lever  
(2 ea)



Box driver



Drain hose  
(1 ea)



Hose band



O-ring  
(1 ea)



Cleaning brush  
(1 ea)

# Safety Precautions

This coffee machine is used for making espresso out of coffee beans.

Keep this manual close to the product and make it easily accessible to anyone who wants to use it.

If you need information other than what this manual provides, or if there is a problem that cannot be solved by the solution provided, please contact our service center.

[Symbols Used in This Manual]



## Personal Safety Instructions

Failure to follow these safety instructions may result in minor injuries in the event of malfunction.



## Personal Safety Instructions

Failure to follow these safety instructions may result in major/minor injuries in the event of malfunction.



Electric shock



Burn Hazard



Crush hazard



Hot surface



Hazard Slip



Product Damage Hazard

- \* Coffee machine
- \* Facilities in the installation site
- \* Always follow the instructions in the user manual correctly.



Note/Tips

- \* Tips for Safe Handling and Easy Operation



The conditions described below will void the product warranty, and Donggu Electronics assumes no liability for product defects caused by the following:

- \* Defects caused by improper use (caused by ignoring the instructions)
- \* Problems caused by repairs performed by parties other than our authorized service centers
- \* Problems caused by unauthorized change of the power cord
- \* Problems caused by unauthorized modification or alternation of part of the product
- \* Problems caused by using or storing the product outside the proper temperature range (10 to 40 °C)
- \* Problems caused by the use of parts and accessories not produced by Donggu Electronics Co., Ltd.
- \* Installation, maintenance, or repair by a technician not authorized by Donggu Electronics Co., Ltd. may cause danger to users.
- \* The installation, maintenance, and repair of the product must be carried out only by a technician authorized by the manufacturer.
- \* The manufacturer is not responsible for any unauthorized installation, maintenance, and repair.



Do not let water or other liquids get inside the machine as it may cause electric shock. Please be careful as the hot water is very hot! Avoid direct contact with the hot water. Watch out for burns!



- \* Make sure that the power outlet has a ground wire.
- \* Do not plug multiple products into one power outlet at the same time or into a loose power outlet.
- \* Do not touch the power cord with wet hands.
- \* If the power cord or power outlet is damaged, please stop using the product and request for repair.



Be sure to install this product indoors away from direct sunlight.



Children are usually not aware of the dangers of electrical appliances, so be careful when children are nearby; do not let them play with this machine.

# Installation and Operation

- \* This coffee machine must be installed and operated for the first time by a service technician authorized by the manufacturer.
- \* Be sure to use a direct supply of water system with a water filter. (Use the 1/4" water purifier hose to connect to the product.)

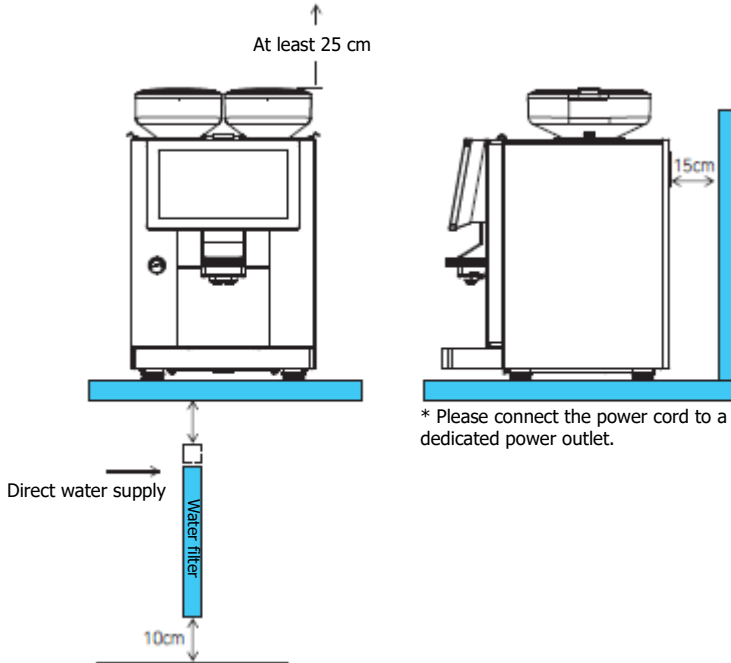

## Installation Conditions

- \* Never install the product near flammable materials or heat sources.
- \* The device is not suitable for outdoor use. Never expose the coffee machine to weather conditions such as rain, snow, or frost.
- \* The product should be installed on a flat, stable surface in a place where it can be supported without any deformation.
- \* The ambient temperature of 10 to 40 °C is suitable for installation.
- \* The relative humidity should not exceed 70%; if the machine has been exposed to sub-zero temperatures, contact our authorized service center.
- \* Be sure to use a direct supply of purified water.
- \* The temperature of the supply water should not exceed 30 °C, and the optimum water pressure should be 1 to 3 bar, not more than 6 bar. If it exceeds 6 bar, please use the pressure relief valve.

## ● Installing/Removing the Bean Canister

### [Installing the Bean Container]

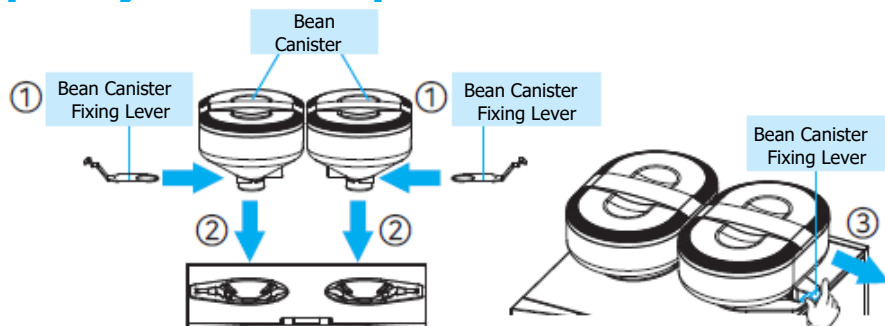

- \* Insert the ① bean Canister fixing levers in the left and right directions as shown in the picture and push them in completely. ② Make sure the bean Canisters are in place.
- \* ③ Pull the bean Canister fixing lever in the direction of the arrow to secure the Canister

### [Removing the Bean Canister]



- \* Push the bean Canister fixing lever in the direction of the arrow.



- \* Remove the bean Canister by lifting it.



### Personal Safety Instructions

Failure to follow these safety instructions may result in minor injuries in the event of malfunction.

\*Always follow the instructions in the user manual correctly.

## ● Filling the Bean Canister



- \* Open the lid of the bean Canister and fill it with beans.
- \* Close the lid of the bean Canister
- \* Large-capacity bean canister(1,200 g)
- \* 2-container system



Please fill the bean canister with roasted coffee beans only. Adding bean grinds, beans processed with sugar, caramel, etc., liquids containing sugar, green beans or blended beans with them, etc. may cause product failure.

# Installation and Operation

## Adjusting the Grind Level

\* The default grind level of this product is set to fine grind.

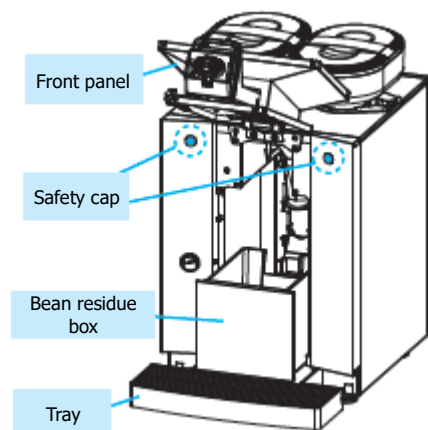

\* Lift the coffee nozzle and remove the tray and the coffee bean residue box.

\* Lift the front panel and remove the safety cap (L/R).

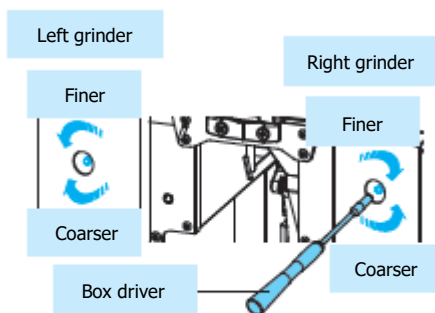

\* Adjust the size of the grind by using the box screwdriver provided with the product.

### [Left grinder]

- Turn it clockwise: Coarser grind
- Turn it counterclockwise: Finer grind

### [Right grinder]

- Turn it clockwise: Finer grind
- Turn it counterclockwise: Coarser grind

## Adjusting the Coffee Nozzle

Hold the coffee nozzle handle and move it up and down to adjust the nozzle based on the height of the cup.

If there is a large difference in height of the coffee nozzle and cup, your coffee may splash out of the cup.

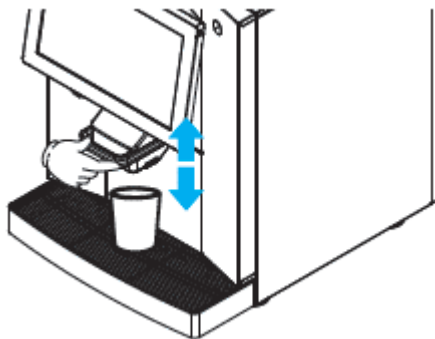

※ Refer to the images in the Cleaning item on the left side of the Administrator Mode screen.



## Lifting the Front Panel

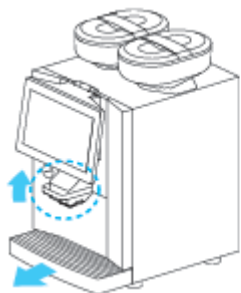

Lift the coffee nozzle handle completely and pull out the tray.

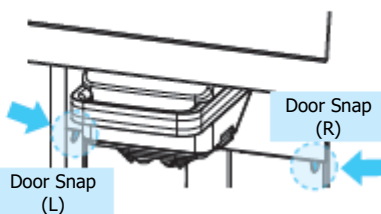

Press until the protruding door snaps (L/R) inward.

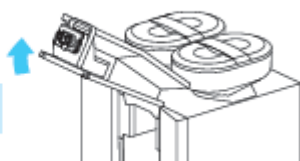

Lift the front panel.

## Rinsing the Brewer

※ Refer to the image in the  Cleaning item on the left side of the Administrator Mode screen.

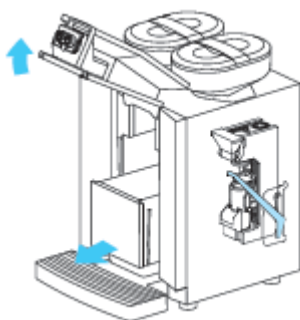

Pull out the tray and the bean residue box. Lift the front panel.

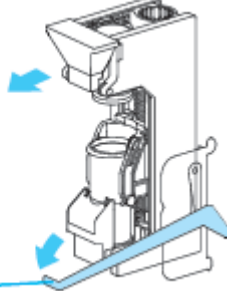

Lower the lift lever and pull out the brewer from the product.

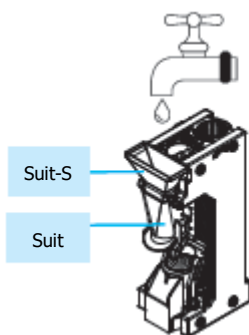

Wash the brewer clean with water and shake it off to remove excess water. Wipe the inside of the suit and suit-S with dry cloth to remove moisture.  
 ※ Failure to remove it may cause coffee bean powder

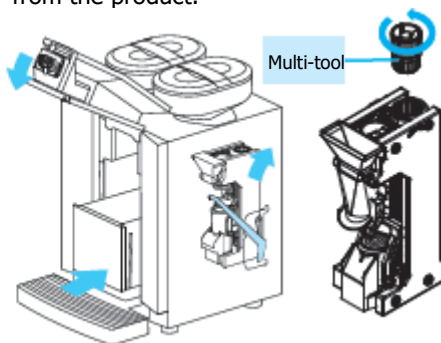

After placing the brewer, raise the lift lever. Push down the front panel. Push in the tray and the coffee residue box.  
 ※ If you cannot raise the lift lever smoothly, remove the brewer, turn the slot slightly using the multi-tool, and

# Installation and Operation

to form a lump that can cause clogging.

place it back to the product.

## Cleaning the coffee nozzle

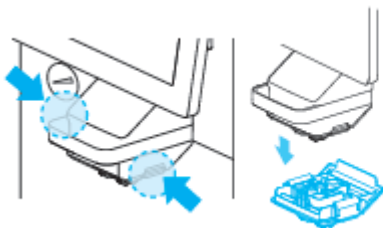

Press both sides of the coffee nozzle to remove the lower part of the nozzle.

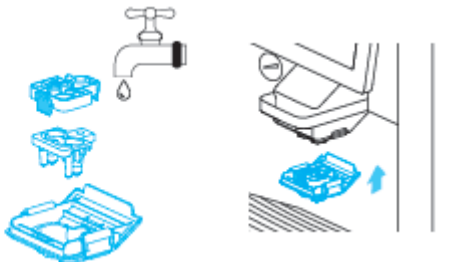

Remove the lower part of the nozzle as shown in the figure, wash it clean, and assemble it back to the coffee nozzle.

## Emptying the bean residue box

※ If the color of the  icon changes to red on the screen, please empty the bean residue box as shown below.

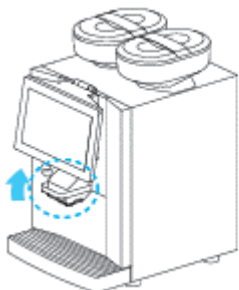

Lift the coffee nozzle handle completely.

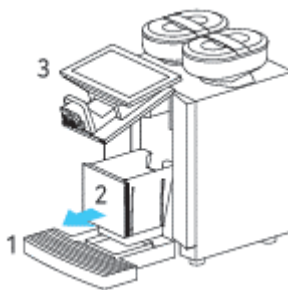

1. Pull out the tray.
2. Pull out the bean residue box.
3. Lift the front panel.

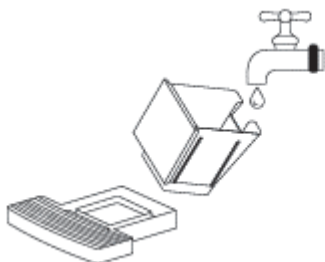

Empty the residue in the bean residue box and wash the bean residue box and the tray with water.

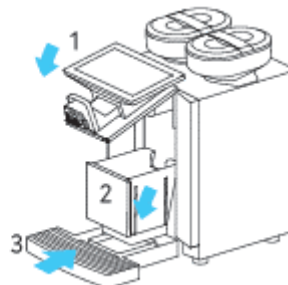

1. Push down the front panel completely.
2. Push in the bean residue box.
3. Push in the tray.

## Start screen

- \* When the coffee machine is connected to the power source, it turns on and starts the initial booting process (Android).



- \* Click the power  icon to switch to the product initialization step.



- \* Reinforced glass is used for the control panel. Note, however, that it may still break if external shock or excessive force is applied. Be careful when tapping the panel.

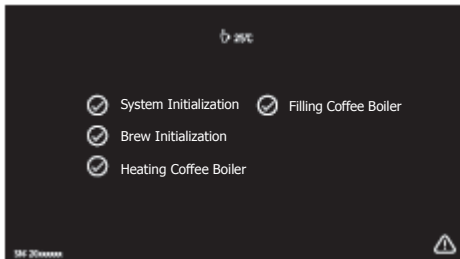

- \* The product initialization process begins. When each initialization step is complete, the  checkbox will be checked.

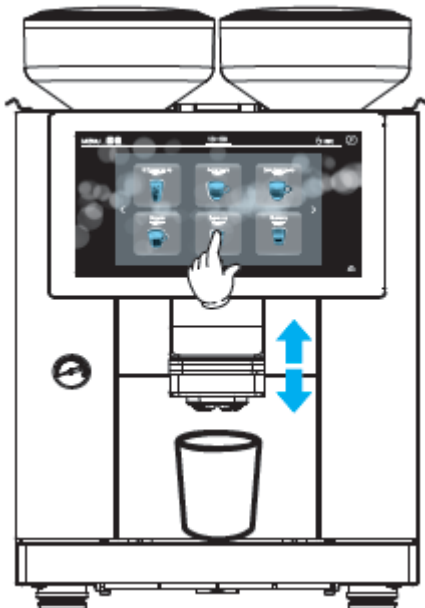

### [Ready]

- \* When the coffee machine is ready to extract coffee, such is indicated on the screen.
- \* Fill the bean container with coffee beans and open the bean container fixing lever. (See the Installing/Removing the Bean Container page.)

### [Sales Operation]

- \* Place the cup under the drink nozzle, adjust the nozzle height, and select the icon of the drink you wish to sell to start the selling process. When selecting a drink, tap the < and > icons next to the drink icon to go to the previous and next pages, respectively, on the screen.
- \* If you do not have enough beans, replenish the beans and tap the Re-run button to resume sale. Please note that this does not indicate failure.

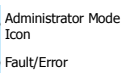
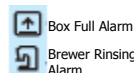

# Installation and Operation

## Single Sale

- \* Single Sale is used to process single sale of the tapped drink menu only.



- \* Place the cup under the coffee nozzle
- \* and tap the icon of the desired drink to start extracting the selected drink.

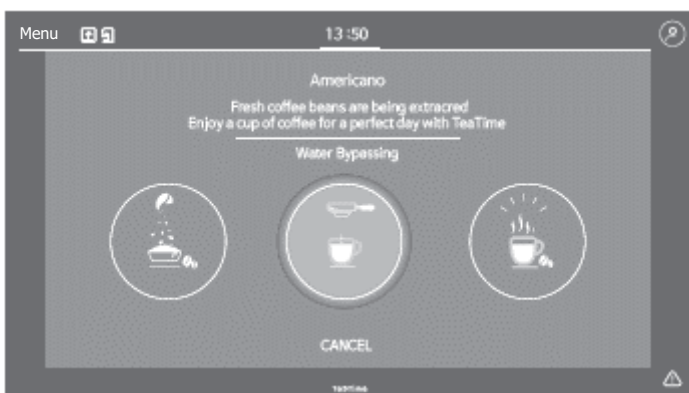

- \* The name of the selected drink and extraction process are shown in order on the screen.
- \* If extraction is complete, it will switch to the standby screen.
- \* If you tap CANCEL during extraction, the extraction process will be stopped.

[Use 2 cups (two-shot)]

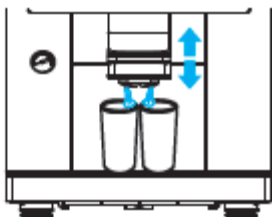

- \* If "shotx2" is shown below the name of the drink, you can make two cups of the drink as shown in the left figure.
- \* Place two cups under the coffee nozzle and select the drink to make them one by one.

## Multi-Sale

- \* Multi-Sale is used to process continuous multiple sales of several drink menus, and up to 10 cups can be selected.



- \* When selected, the selected drink is added to the column on the left side, and the number of cups will be shown on the screen.

- \* Tap START to start extracting the first drink at the top.

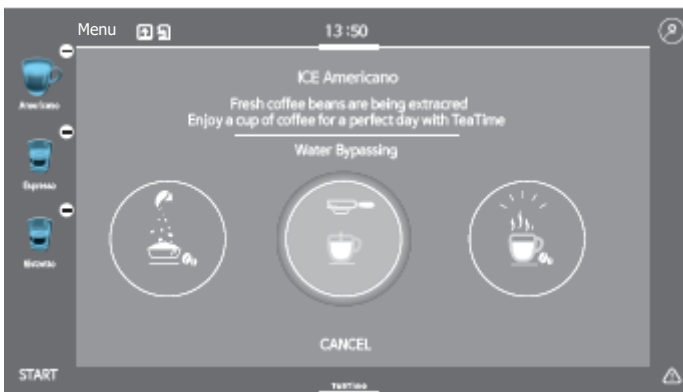

- \* The drink being extracted will be removed from the column, and the next selected drink will be shown at the top.

- \* Tapping the "-" icon next to the drink icon in the column will cancel the drink. Be careful not to tap it by mistake.



- \* In Auto mode, When extraction is complete, the extraction process of the next drink will start automatically. Replace the cup before the next one starts coming out through the nozzle.

- \* In Pick-up mode, the pick-up icon is displayed as shown in the left figure. After replacing the cup, press the "→" icon to start extracting the next drink.

# Administrator Mode

## Entering Administrator Mode

\* Enter Administrator mode by tapping the  icon on the upper right corner of the standby screen.

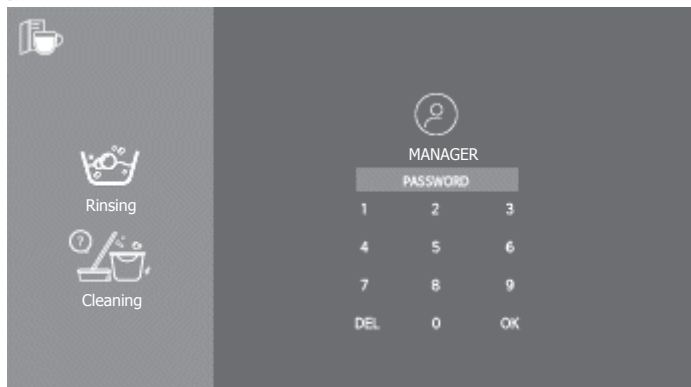

\* The initial password is set to "1111" when the product is shipped.

\* Enter the password and tap OK to enter Administrator mode.

\* If a wrong password is entered by mistake, tap DEL to delete it from the last entered character.

\* Tap the  icon to return to the standby screen.

## Rinsing Mode

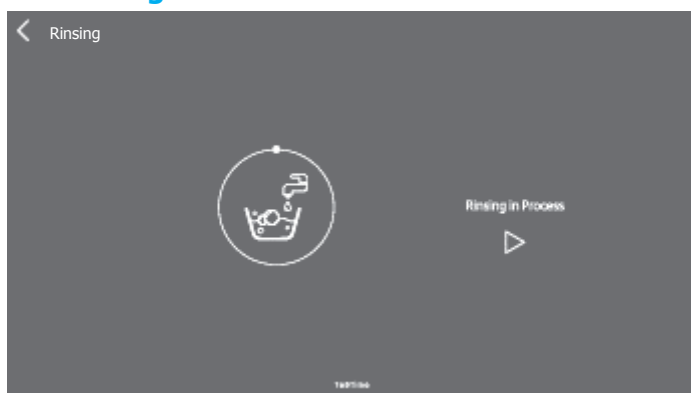

\* On the Administrator mode screen, tap the  (Rinsing) icon to go to the rinsing process screen.

\* Tap the  icon to start rinsing the brewer automatically.

\* During rinsing, tap the  icon to stop the rinsing process.

\* Tap the < icon on the upper left corner to return to Administrator mode.

## Administrator Mode Screen

\* The following screen appears if you enter Administrator mode:



\* Tap the icon of the mode you wish to check or configure the settings for to enter the mode.

\* Tap the  icon to return to the standby screen.

\* If you tap the  icon, the message  appears. Tap OK to return to the Start screen after rinsing the brewer. If you tap DEL, the menu disappears.

## Sales Configuration Settings

### [Singular Sales]

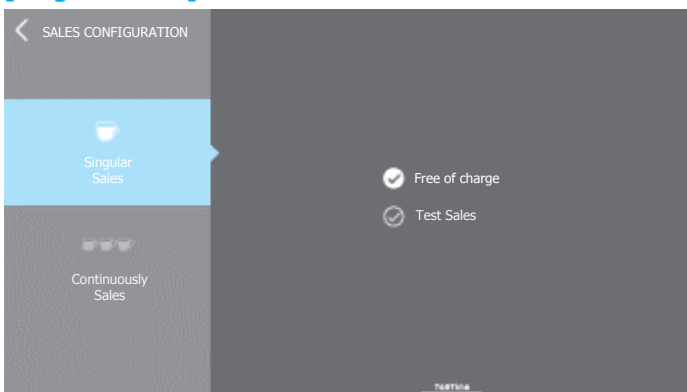

\* For more details on how to use Singular Sales, see the Singular Sales page.

\* Tap the < icon on the upper left corner to return to Administrator mode.

\* Free of charge: Runs a normal sales operation (No Beans state will be detected)



\* Test Sales: Runs a test for sales operation (No Beans state will not be detected)

# Administrator Mode

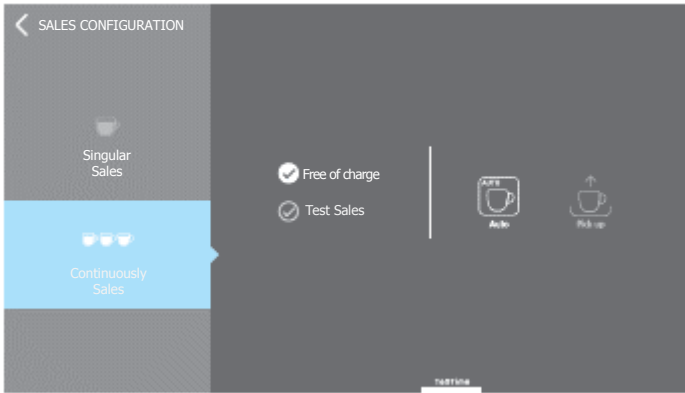
## Sales Configuration Settings [Multi-Sale]



\* For more details on how to use Multi-Sale, see the Multi-Sale page.

- \* Tap the < icon on the upper left corner to return to Administrator mode.
- \* Free of charge: Runs a normal sales operation (No Beans state will be detected)
- \* Test Sales: Runs a test for sales operation (No Beans state will not be detected)
- \* Auto mode  : When the extraction of the selected drink is complete, the extraction process of the next drink will start automatically. Replace the cup before the next one starts coming out through the nozzle. (The drink may splash out of the cup.)
- \* Pick-up mode  : When the extraction of the selected drink is complete, the Pick-up icon will be shown on the screen. It does not start extracting the next drink until the → icon is tapped.

## SALES MANAGEMENT

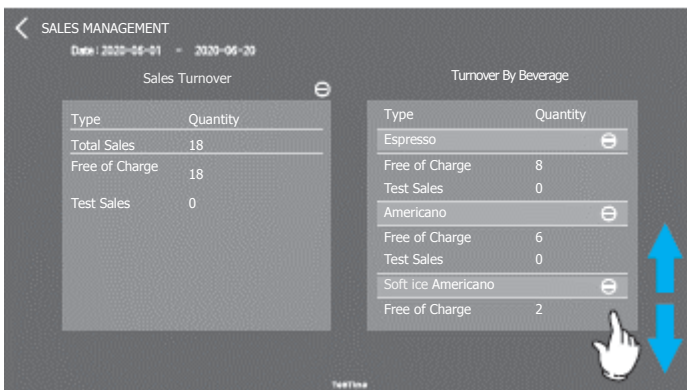

\* Scroll down Turnover by Beverage column as shown in the figure to check the number of cups sold for other drinks.

\* Tapping the ⊖ icon will delete the total number of cups. Please be careful not to tap the icon by mistake.

- \* Tap the < icon on the upper left corner to return to Administrator mode.
- \* Set a period and tap OK to go to the number of cups sold in the selected period. You can scroll up/down the numbers to set the year/month/date and tap the OK button.

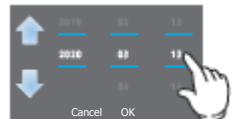



## MENU MANAGEMENT

- \* You can manage menus by changing the order of drinks, set the recipe, register and set a new menu, etc. in this mode.



- \* Scroll up/down the screen in the drink column on the right to navigate the screen.

- \* Tap the < icon on the upper left corner to return to Administrator mode.
- \* Tap the ↺ icon on the lower left corner to return to the default drink menu settings.
- \* Tap the ⊖ icon to remove the drink and show the "+" mark instead.
- \* Tap the < > icon at the central pane to go to the previous/next page.  
The drink screen can show 6 different drinks in one page. The list can have 13 basic menus. By adding new menus, the list can have up to 18 drinks
- \* When the settings are complete, tap the  icon to save the change. "Saved" will appear on the screen.

### [Add Drink]

- \* Tap the "+" in the central pane to change it to "✓".
- \* Find and tap the drink you wish to add to complete the change.
- ※ If the drink is already in the list, it cannot be added again.

### [Move Drink]

- \* To relocate a drink in the list, tap the ⊖ icon of the drink you wish to move or switch places to remove it. Then use the Add Drink feature to place it back to the list.

### [Recipe Settings]



- \* Tap the drink icon to set a recipe for from the central pane or the column on the right to go to the Recipe Settings screen.

- \* Be careful not to tap the ⊖ icon when tapping a drink icon.

# Administrator Mode



\* You can scroll up/down the screen to move between the recipe settings items.

- \* Tap the **X** icon on the upper right corner to return to Administrator mode without saving the changes.
- \* When the settings are complete, tap the **☑** icon to save the changes.
- \* Tapping the **⊖** icon on the lower right corner will delete the selected drink and return to the Manage Menu screen. You cannot delete the 13 basic menus. This feature only applies to the new menus created by the operator.

## [Settings Items]

1. **PRODUCT TYPE:** Used to select the type of drink. Choose between COFFEE, AMERICANO, and ICE AMERICANO. Once selected, the settings items are updated according to the type.
2. **COUNTED PRODUCT:** Used to set the amount: shotx1 or shotx2. The selected item will be highlighted with a circle outline.
3. **SELECT GRINDER:** Used to select the grinder: Left or Right. The selected item will be highlighted with a circle outline.
4. **COFFEE QUANTITY:** Used to set the grinding time for the selected grinder.
5. **WATER QUANTITY:** Used to set the extraction amount, i.e., espresso amount.
6. **PRE-INFUSE:** Used to set the amount for pre-infusion to run before extraction.
7. **DELAY PRE-INFUSE:** Used to set the resting time after pre-infusion.
8. **INITIAL PRESSURE:** Used to set the initial pressure in the brewer. Tap the **< >** icon to adjust the level.
9. **BYPASS SEQUENCE:** Select from N, A, B, and W. The selected item will be highlighted with a circle outline.
  - (1) "N": Do not run the bypass sequence (Espresso, Doppio, etc.)
  - (2) "A": Run the bypass sequence after extraction
  - (3) "B": Run the bypass sequence before extraction
  - (4) "W": Run the bypass sequence starting from the grinding process
10. **BYPASS WATER:** Used to set the amount of hot water to dilute the extraction.

## [Adjustment]

\* For items such as coffee quantity and water quantity with the scroll bar to the right, drag the circle left/right to configure a rough setting and fine-tune the value using the **< >** icon.

## [Change Drink Image/Name]

- \* Tap an image among the drink images in the column on the right to update the image of the drink.
- \* Tap the name of the drink on the left to go to the keyboard screen. You can add numbers, English letters, icons, etc. to the drink name. The keyboard screen will disappear if you tap anywhere outside the keyboard area.

## [Register New Menu]

- \* You can create up to 19 new menus.



- \* Tap an image among the drink images in the column on the right to add the image of the drink on the left side.
- \* Tap Default on the left to go to the keyboard screen. You can add numbers, English letters, icons, etc. to the drink name. The keyboard screen will disappear if you tap anywhere outside the keyboard area.

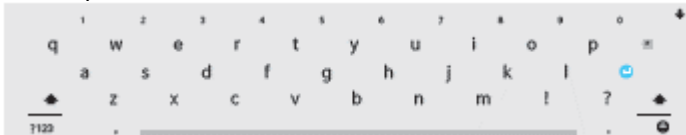

- \* Refer to the Settings Items section. Set a recipe for the new menu and tap the  icon to save the recipe.



# Administrator Mode

## SYSTEM SETTING



\* Tap the < icon on the upper right corner to return to Administrator mode without saving the changes.

### [Password]

\* Tap four digits followed by OK to reset the password.

\* If a wrong number is tapped by mistake, tap DEL to delete the last entered one.

### [Time]

\* Tap the Time item on the right to go to the settings screen.

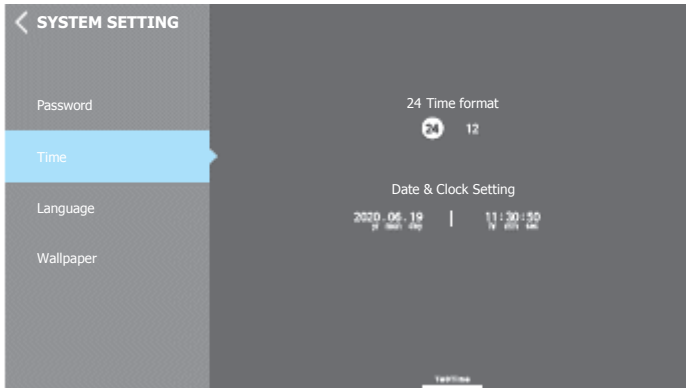

\* Tap the < icon on the upper right corner to return to Administrator mode without saving the changes.

### [24 Time format]

\* 24: 24-hour format. 00 to 24.

\* 12: 12-hour format. AM/PM is indicated before the time.

\* Tap to select 24 or 12.

### [Date & Clock Setting]

\* Tap the Year/Month/Date area to go to the settings screen. Scroll up/down to set the Year/Month/Date and tap OK.

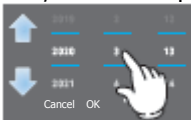

\* Tap the Time/Min/Sec area to go to the settings screen. Scroll up/down to set the Time/Min/Sec and tap OK.



## [Language Settings]

\* Tap the Language item on the right to go to the settings screen.

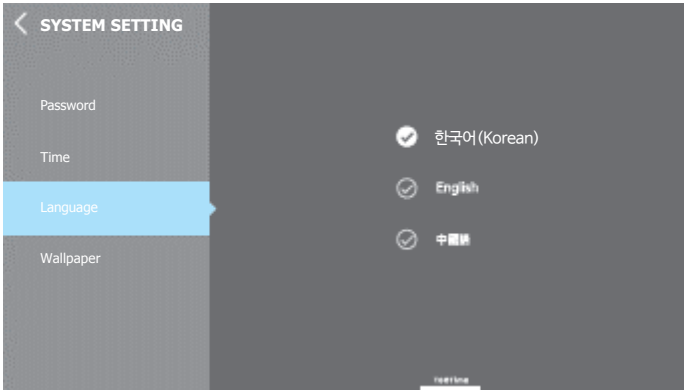

\* Tap the < icon on the upper right corner to return to Administrator mode without saving the changes.

\* Select a language and tap the < icon to shift to administrator mode. The selected language will be applied.

## [Wallpaper]

\* Tap the Wallpaper item on the right to go to the settings screen.

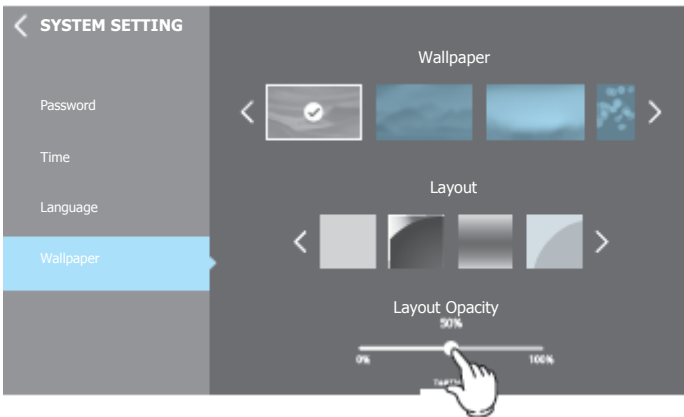

\* Tap the < icon on the upper right corner to return to administrator mode without saving the changes.

\* **Wallpaper:** Used to set the background of the standby screen.

Use the < > icons to check the backgrounds and tap to select one. The selected image will be marked with the icon.

\* **Layout:** Used to select the layout of the drink cup on the standby screen.

Use the < > icons to check the backgrounds and tap to select one. The selected image will be marked with the icon.

\* **Layout Opacity:** Used to set the layout opacity for the selected drink.

Drag the circle to the left/right as shown in the figure to adjust the opacity. The closer to 0%, the more transparent it is. The closer to 100%, the more non-transparent it is.



# Administrator Mode

## ERROR INFORMATION

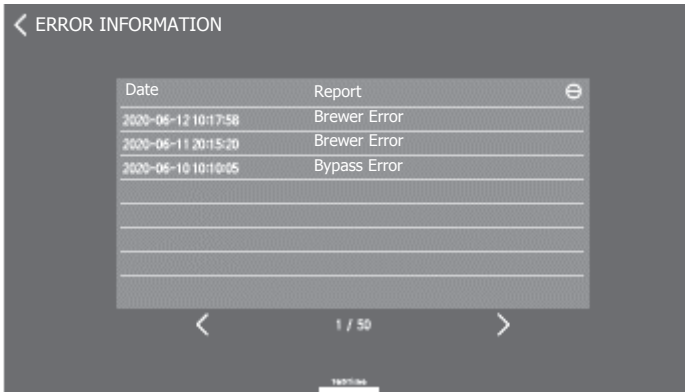

- \* Tap the < icon on the upper right corner to return to administrator mode.
- \* The date and details of errors that occurred will be shown on the screen.
- \* Tap the < > icon to go to the previous/next page.
- \* Tap the ⊖ icon to delete the error record.
- \* Up to 50 pages can be stored. If it exceeds the limit, the oldest records will be deleted first and replaced by the recent ones.

## LOAD TEST

- \* This feature is used to test the product for errors. The components or drive unit circuits can be checked for failure.

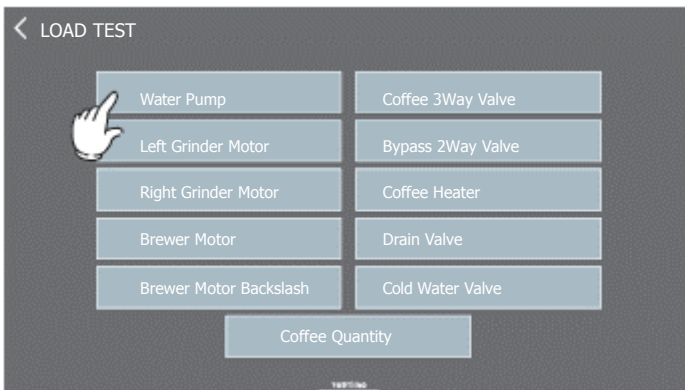

- \* Tap the item you wish to test to go to the test screen.
- \* Tap the < icon on the upper right corner to return to administrator mode.

※ Only trained technicians should carry out the test.

## [LOAD TEST]



- \* Tap the ▷ icon to start the load test.
- \* During the load test, tap the ✕ icon to cancel (stop) the test.
- \* When testing is complete, tap the < icon on the upper right corner to return to administrator mode.

## [Coffee Quantity]

- \* This feature is used to check the grind level set in the grinder and amount of bean powder.

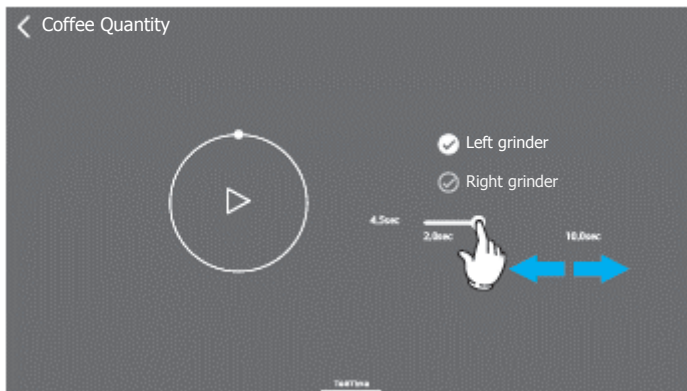

- \* Remove the brewer from the product. (See the Rinsing the Brewer page.)
- \* Tap to select the grinder (L/R) you wish to test.
- \* Set the test time by dragging it as shown in the figure.
- \* If you tap the ▷ icon with a cup or a container under the nozzle of the grinder, the bean amount test will start.
- \* When testing is complete, tap the < icon on the upper right corner to return to administrator mode.
- \* Assemble the brewer back to the product.

# Administrator Mode

## MACHINE SETTING

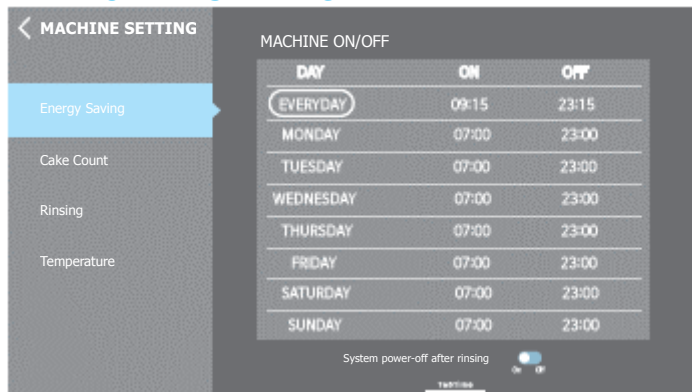

\* Tap the < icon on the upper right corner to return to administrator mode.

### [Energy saving]

\* This feature is used to set the time for turning on/off automatically daily or on a set day of the week.

\* Tap the day of the week to turn on the feature.

\* If you tap the time for turning on/off the product on the selected day of the week, the settings screen will appear. Configure the settings by scrolling up/down as shown in the figure.

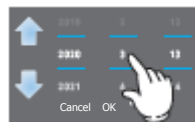

- ON: Time for turning on the product/OFF: Time for turning off the product

\* System Shutdown after Rinsing: Sets whether to run the brewer-rinsing process before shutting down the product.

- ON: Rinse the brewer/OFF: Do not rinse the brewer

### [Cake Count]

\* This feature is used to count the number of runs to issue an alarm for emptying the residue box.

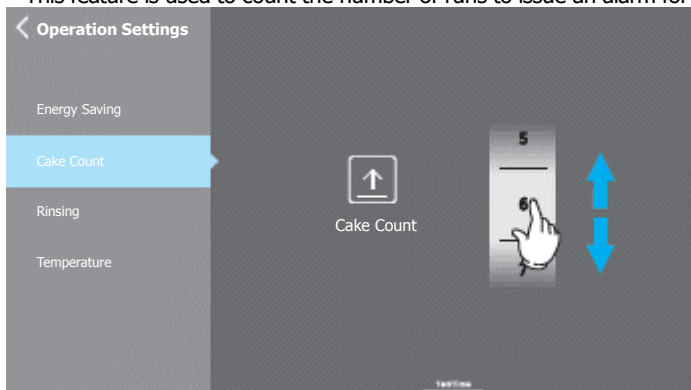

\* Tap the < icon on the upper right corner to return to administrator mode.

\* Scroll down/up the number part to set the count.

- 0: Do not count / 1 to 100: Count the runs against the set number

\* When it reaches the set count, the alarm  icon for emptying the bean residue box turns red. You can still continue selling the drink.



## [Rinsing Frequency]

\* This feature is used to set the frequency for the automatic rinsing of the brewer while the product is turned on.

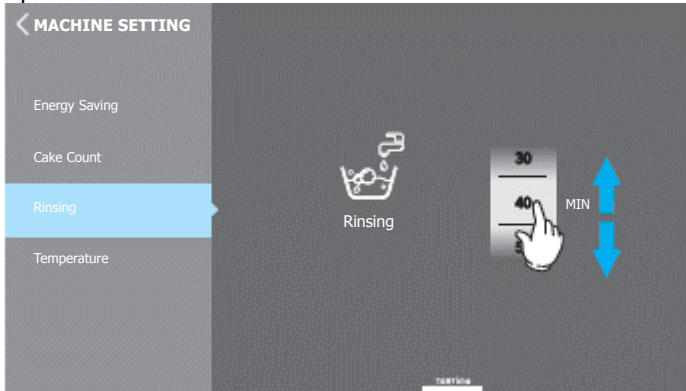

\* Tap the < icon on the upper right corner to return to administrator mode.

\* Scroll down/up the number part to set the frequency.

- 0: Do not run automatic rinsing / 10 to 600 minutes: Run automatic rinsing with the set frequency

\* When the frequency is set, it switches to standby state and executes countdown of the time.

※ If you leave the product unattended for an extended period of time (for annual leave, holidays, etc.) while it is turned on, this may cause overflow in the tray.

## [Temperature]

\* This feature is used to set the control temperature in the boiler. Please note that this is not the temperature of the drink you are selling.

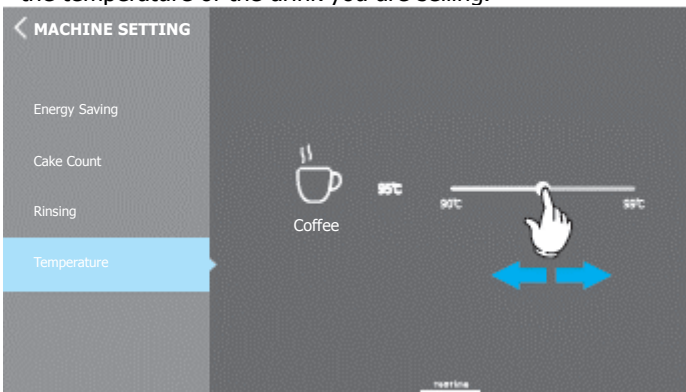

\* Tap the < icon on the upper right corner to return to administrator mode.

\* Drag the circle left/right as shown in the figure to set the temperature.

# Administrator Mode

## INFORMATION

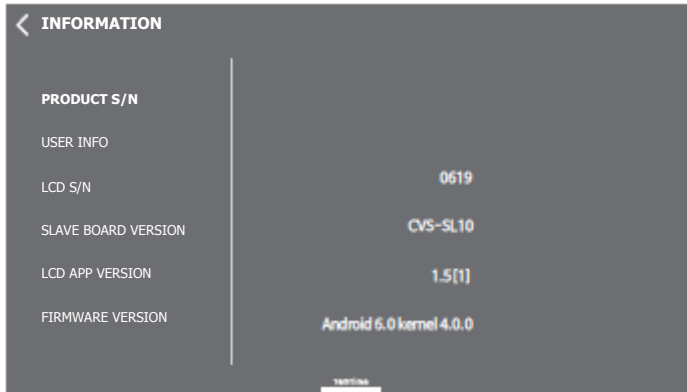

- \* Tap the < icon on the upper right corner to return to administrator mode.
- \* The version and specifications of the control parts/circuits of the product are displayed, and the version information will be updated automatically when updating the product.

## Product specification

Model name	i-Creo
Dimensions	420(W)X680(H)X530(D)
Power	220V~ 50/60 Hz
Rated Power Consumption	2.2 KW
Bean canister	2 ea
Display	TIFT LCD (13.3") Touchscreen
Weight (Kg)	Appx. 43Kg

- \* The product may be subject to design and technical changes without prior notice to improve the quality of the product.

All rights including the copyright and rights for copying, distributing, or translating this document are protected by law. Editing, copying, or distributing all or part of this manual using electronic systems or reproducing it in any form without written permission is prohibited.



## **Dong Gu Electronics Co., Ltd**

6, Dunchon-daero 497beon-gil, Jungwon-gu, Sungham-si, Gyeonggi-do, Korea

Tel. 82-31-731-3600 ext. 731~733

Fax. 82-31-733-1155

Web site. <http://www.venusta.co.kr>